



Shanghai Pengwang Machinery Co., Ltd.

Address: Building 8, No.1098, Chuansha road, Pudong New Area, Shanghai
Sales phone: +86 15801732387

PW801 Hot Air Blower

Manual



Maintenance records

Warranty Card Inspector: _____			
Date	Failure issue	Maintenance	Remark

Product profile

It is a cost-effective and high-power plastic hot air blower developed by us. Only one of the domestic similar products to adopt a single-chip precise temperature control system, with a temperature accuracy of one degree error; Unique dual-digital temperature control display, make sure the set temperature and real-time temperature are clear at a glance; Use both temperature and air speed to be adjustable Mode to meet the requirements of different air speeds; Only automatic delay shutdown design is adopted to ensure that the gun core is forced to cool down after the shutdown.

Not only refers to the domestic and international general air duct and nozzle size to ensure the versatility of the product; Also adopts pocket barrel design to meet the convenience of domestic users to hold and meet the optimized ergonomic parameter model . The body adopts lightweight design, low noise, large air volume, strong wind, high power, fast heating, and long life.

Performance

1. Voltage: 220V-240V
2. Frequency: 50/60Hz
3. Power: 1600W
4. Temperature range: indoor-550°C
5. Air volume (20°C): 230L/min
6. Weight with power cable: 1.38Kg
7. Out size: 420mm*220mm*140mm
8. Insulation grade: A
9. Noise: 70db



Application

1. Applicable for welding various plates, pipes, mold lining films, coating materials, films, foams, sheets, and blocks made of thermoplastic materials, single-layer soft plastics and modified asphalt;
2. It can be heated to form, bend and seal for thermoplastic semi-finished products and plastic particles; also can blow dry the surface wetted by water, or wet instruments;
3. Shrink heat shrinkable sleeves, films, tapes, welding sleeves and molded parts; Defrost frozen water pipes; Melt solvent-free viscous substances and synthetic glue;
4. Widely used in national defense and military facilities engineering, anti-corrosion chemicals, electricity plastic, PVC (board, pipe) engineering installation in plating, pharmaceutical industry, rural areas, fish villages, islands and other places, as well as production and repair of farm tools, fishing gear and equipment.
5. The following welding methods can be used: overlap welding, electrode welding, ribbon welding, butt welding and fusion welding.

Notes

1. Before operating, please read the instruction manual carefully, and ensure that the safety regulations are complied;
2. The rated voltage is 220V, higher or lower than the rated voltage may cause machine failure, and even cause irreparable damage, please check whether the working voltage meets the requirements before use;
3. When using the machine on a construction site or outdoors, a leakage protection circuit breaker must be installed(RCCB), in order to protect worker;
4. Damaged power cable may cause a fatal electric shock. Be sure to check the power cable regularly. If it is damaged, it must be repaired or replaced by a professional electrician. Otherwise, you cannot continue to use the machine;
5. If the casing is damaged or disassembled, it may cause a fatal electric shock. If you need to repair, replace, and maintain the casing and internal parts of the casing, be sure to unplug the plug from the socket first to ensure that the machine is in a non-powered state;
6. Warning: Operating the machine in rain or humid environment may cause fatal electric shock. Please ensure that the machine is stored and used in a dry environment;
7. Under normal use of the hot air blower, the temperature of the stainless steel air duct and the nozzle is extremely high. Please make sure that the air nozzle is not aimed at flammable and explosive objects, and that the air nozzle is not aimed at children or other people's bodies; do not allow children or non-professional operators to approach the machine; do not use the machine to heat liquids; no volatilization in the working environment Flammable materials; stainless steel air ducts and nozzles at work must not touch flammable and explosive objects;
8. Using this machine in a dusty environment is likely to cause machine failure or even damage, which will make the machine to catch fire.

Issue analysis

Issue	Analysis	Solution
Temperature is too high Can't be adjusted	Temperature control circuit board doesn't work	Modify temperature control circuit board or return to factory for repair
	Blocked air vents and poor ventilation	Use wire to unclog the vents
	Thermocouple failure	Modify thermocouple
	SCR short circuit	Replace the circuit board or return to the factory for repair
Temperature high and low	Poor pin contact	Pull out the gun core and polish the pin surface
	Loose wire joints	Find the loose point, repair welding
Does not heat up	Damaged gun core	Modify gun core
	Overheat protector burned out	Modify overheat protector
	Thermocouple failure	Modify thermocouple
Motor carbon brush with sparks	Carbon brush is worn out	Modify carbon brush
Air volume becomes smaller	Wind blade deforms and melts	Modify wind blade
	Blocked air inlet	Unblock the air inlet
	Air volume adjust knob loosens	Modify potentiometer
	Blocked air outlet	Unblock the air outlet
Abnormal noise	Deformation of the blades and scraping of the cylinder	Adjust the blade gap and replace the blade
	Bearing wear	Modify the bearing or rotor, or motor
	Sand mixed into the fan blades	Clean the motor and fan blades
Power failure	Power touch key failure	Replace the switch or circuit board
	Power cable is broken	Re-wire, or modify

Operation & maintenance

1. Choose the correct nozzle according to requirements, and use tools to lock the nozzle screw to prevent it from falling off suddenly during work;
2. Plug in the power supply, check the safety of the environment and check whether the working voltage of the welding gun meets the requirements of the rated voltage;
3. Long press the POWER button for three seconds, the LED indicator will light up and display "ON", and the machine will enter the working state;
4. Press the up and down arrow keys to adjust the set temperature. Long press is the quick adjustment mode; The value on the red light is the set temperature value; the value on the yellow light is the real-time temperature value;
5. Adjust the air volume & knob to the required air volume;
6. After use, press and hold the POWER button for three seconds, the LED will display "OFF" and enter the shutdown mode. The machine will automatically continue to blow cold air until the nozzle temperature drops to the design temperature, and then automatically shut down.
7. When it is turned on again, the machine will directly memorize the temperature value set last time, which is convenient to use and operate;
8. Regularly clean the dust on the air inlet filter with a small brush, and keep the air inlet clean at any time;
9. Frequently clean stainless steel air ducts and nozzles to prevent clogging of the nozzles and corrosion of stainless steel;
10. When the carbon brush is consumed to the min. length, the machine will automatically stop. The service life of the carbon brush is about 1600 hours. If the carbon brush requires to be replaced due to the consumption, please hand it over to a professional electrician or maintenance company to replace a qualified carbon brush;
11. Make accurate use of the machine's automatic delayed cooling shutdown function, and don't forcibly unplug the power supply during the automatic cooling.

Structure schematic

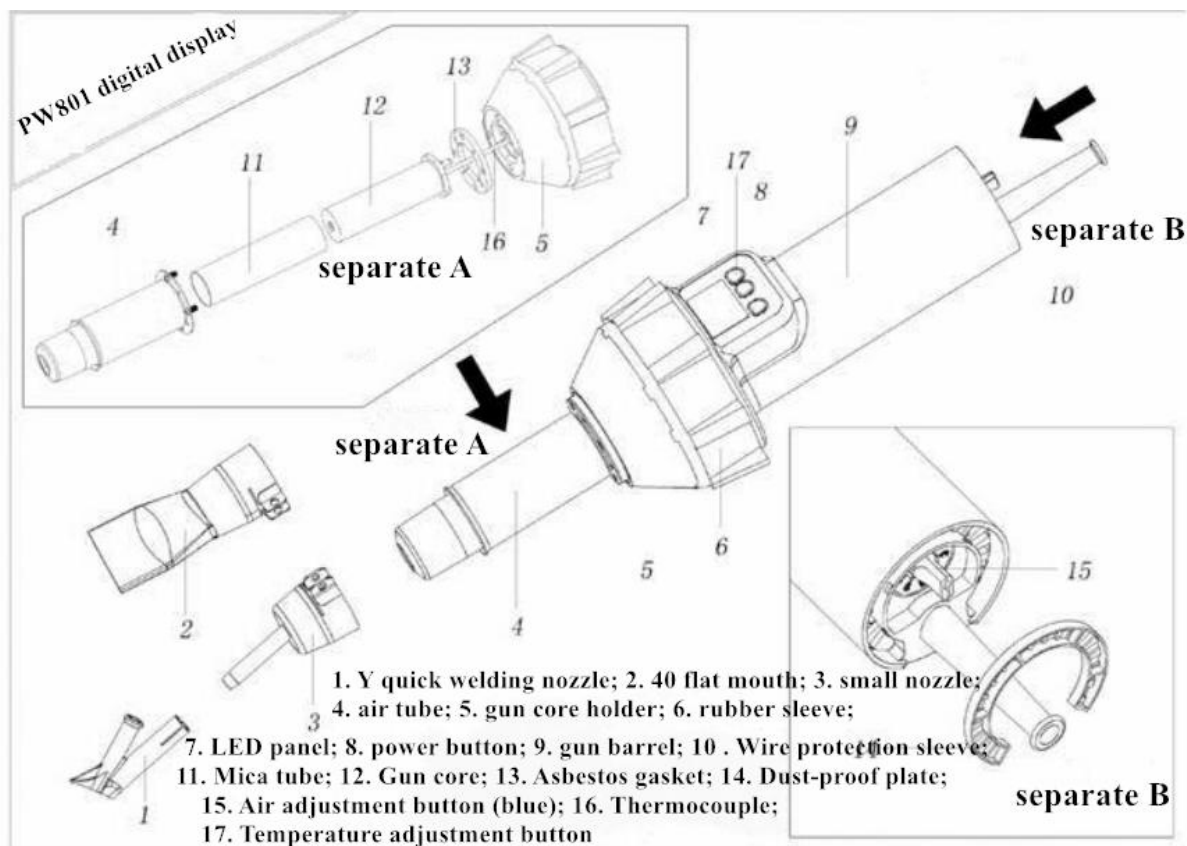

Circuit connect diagram

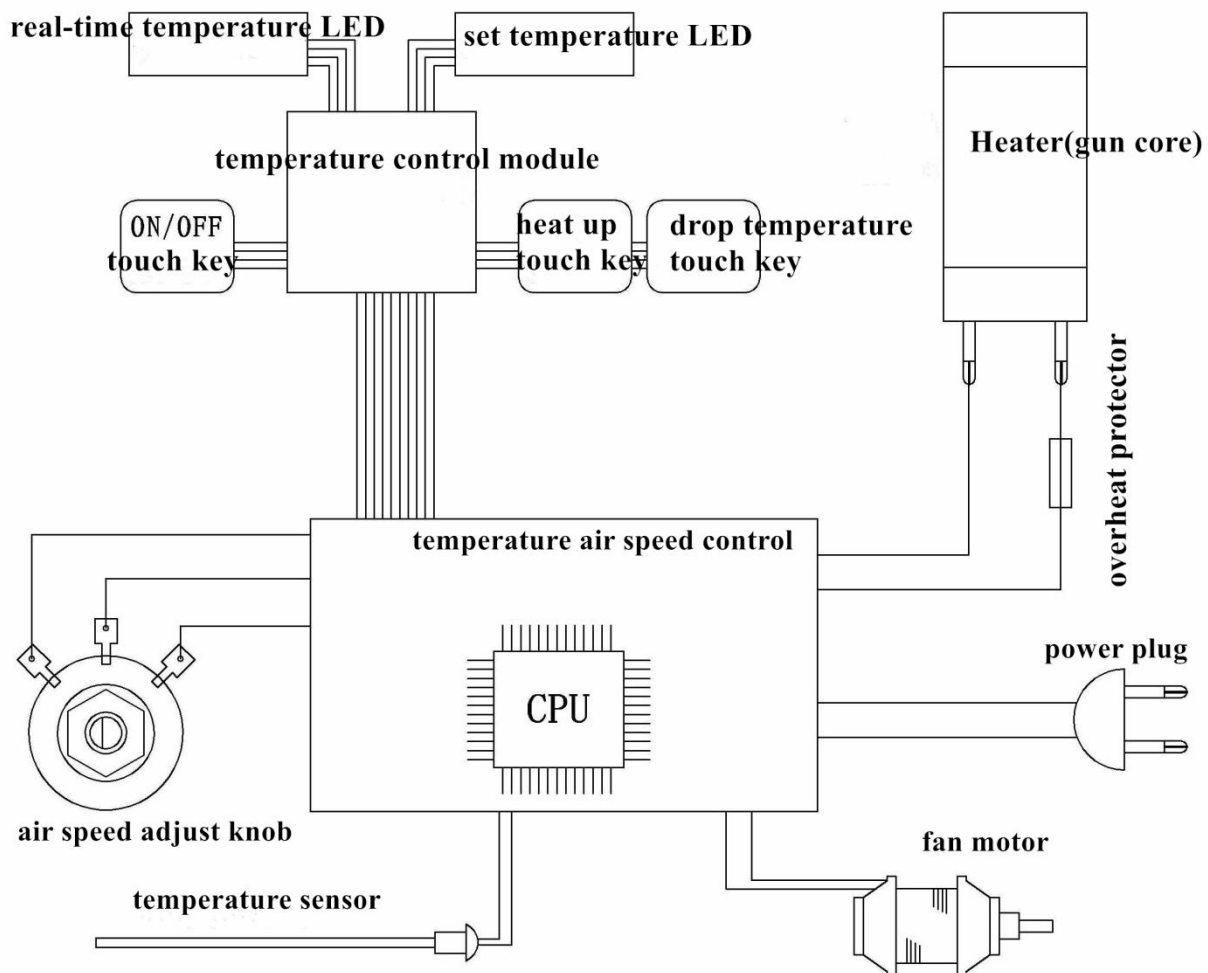

Schematic diagram of temperature & air speed control system

Shanghai Pengwang Machinery Co., Ltd.

Address: Building 8, No.1098, Chuansha road,Pudong New Area, Shanghai

Sales phone: +86 15801732387